



riverbank beauty

WATERY TONES
AND LIGHT FINISHES
REFLECT THIS KITCHEN'S
RIVERFRONT SETTING.

writer KATHRYN HOVE
photographer BRIE WILLIAMS
field editor SANDRA L. MOHLMANN

Natural blue tones
come together in this
waterfront kitchen—
from the backsplash
and countertops to
the valance and
barstool fabrics.

Surrounded by the beauty of the riverfront and maritime palmettos and pines,

this home in Kiawah Island, South Carolina, offers breathtaking views from every angle. For owners Jim and Jennifer Powers, the stunning natural setting was the inspiration for their Low Country kitchen.

The home was built by architect Samuel Furr on a deepwater lot along the Kiawah River—complete with a dock and ocean access within minutes. The couple worked with designer Kathryn McGowan to invite the outside in. “It was really important when we were designing this kitchen to take advantage of the view,” Jennifer says.

Maintaining the view, however, meant getting creative with storage. Traditional kitchens use plenty of upper cabinetry, but that would have blocked those cherished vistas of a tidal river that empties into the ocean. The solution: Save the walls for windows, and shift storage to two small enclaves that serve as auxiliary space to the kitchen and provide a walkway into the dining room. One area is a butler’s pantry with a wine refrigerator, a sink, and extra storage for dishware. The other pantry stores food items, a coffee station, and small appliances.



OPPOSITE: An arched range hood and blue-green glass subway tile soften the look of the hardworking range area, giving it a more casual feel. **ABOVE LEFT:** A narrow pullout pantry tucked to the left of the built-in refrigerator maximizes food storage in a central location. **ABOVE:** Sunlight pours into the dining area through a wall of windows. **LEFT:** A vintage-style bridge faucet adds historical elegance.

DESIGN TIP
To maximize both views and storage, use an interior wall for floor-to-ceiling cabinets and dedicate exterior walls to windows.



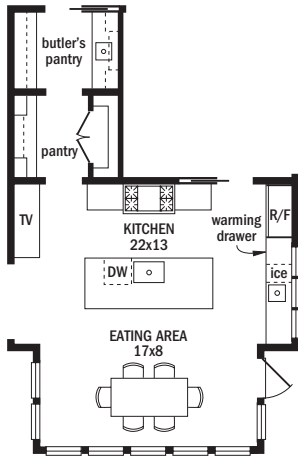

“I don’t like clutter,” Jennifer says. “In the pantry I can close the doors, and you don’t see the appliances.” Because the butler’s pantry is a transitional space, McGowan wanted it to “break up the formality” of the dining room with whimsical elements—a countertop crafted from broken sea glass and shells, and a backsplash with a shell pattern.

Sea green and aquamarine—the primary colors of the outside landscape—inspired the kitchen palette. Glass subway tiles saturate the backsplash with color, and Costa Esmeralda granite countertops emulate the blues and greens of the marshland. Dark floors balance the white walls and crisp linen-white woodwork. The random-plank walnut floors create “a contrast that makes everything pop,” McGowan says. Matching the beauty just outside, the interior ambience makes guests and hosts feel comfortable year-round. **KBI**

RESOURCES BEGIN ON PAGE 134.



OPPOSITE: The shell-pattern tile and a countertop made with broken sea glass add playful doses of color to the butler’s pantry. **ABOVE LEFT:** Glass subway tiles provide a soothing background color. A pot-filler faucet is a convenient accessory above the range. **ABOVE:** A niche in the backsplash offers an out-of-the-way spot to tuck a TV into the kitchen. **LEFT:** The wavy glass panels of these cabinets emulate water—and give homeowner Jennifer Powers a chance to showcase her china collection.

Takeaways

- 1** Dark wood floors provide contrast to a light palette.
- 2** The back side of the island offers storage for seldom-used items.
- 3** Finding alternatives to upper cabinetry creates more space for windows.
- 4** Pantry areas provide additional storage so countertop appliances can be concealed.
- 5** A color scheme inspired by the natural landscape creates a soothing, relaxed atmosphere.

